

11-1-12: TELLURIDE Residence.

970-728-0656 Cel: 970-708-1392

SCHEMATIC DESIGN:

GR DESIGN GROUP, ARCHITECTS:

www.telluridearchitect.com

GENERAL INTERIOR PERSPECTIVES; LIVING ROOM .

PROPERTY OF THE ARCHITECT.

www.aspenarchitect.com



DINING AREA.



11-1-12: TELLURIDE Residence.

GR DESIGN GROUP, ARCHITECTS:

PROPERTY OF THE ARCHITECT.

[970-728-0656](tel:970-728-0656) [Cel: 970-708-1392](tel:970-708-1392)

www.telluridearchitect.com

www.aspenarchitect.com

SCHEMATIC DESIGN: SOUTHEAST PERSPECTIVE: The battered stone column supports help to create the airy base of the home. The deck will not inhibit views from the lower level as the view is at a shallow angle toward the box canyon and Town of Telluride. Trusses frame the views but do not interfere with any mountain peaks. A blanket of blue sky above all peaks completes the view from all rooms. Views from the home are 360 degrees including airport activity, plenty of sunshine and night time astronomy.

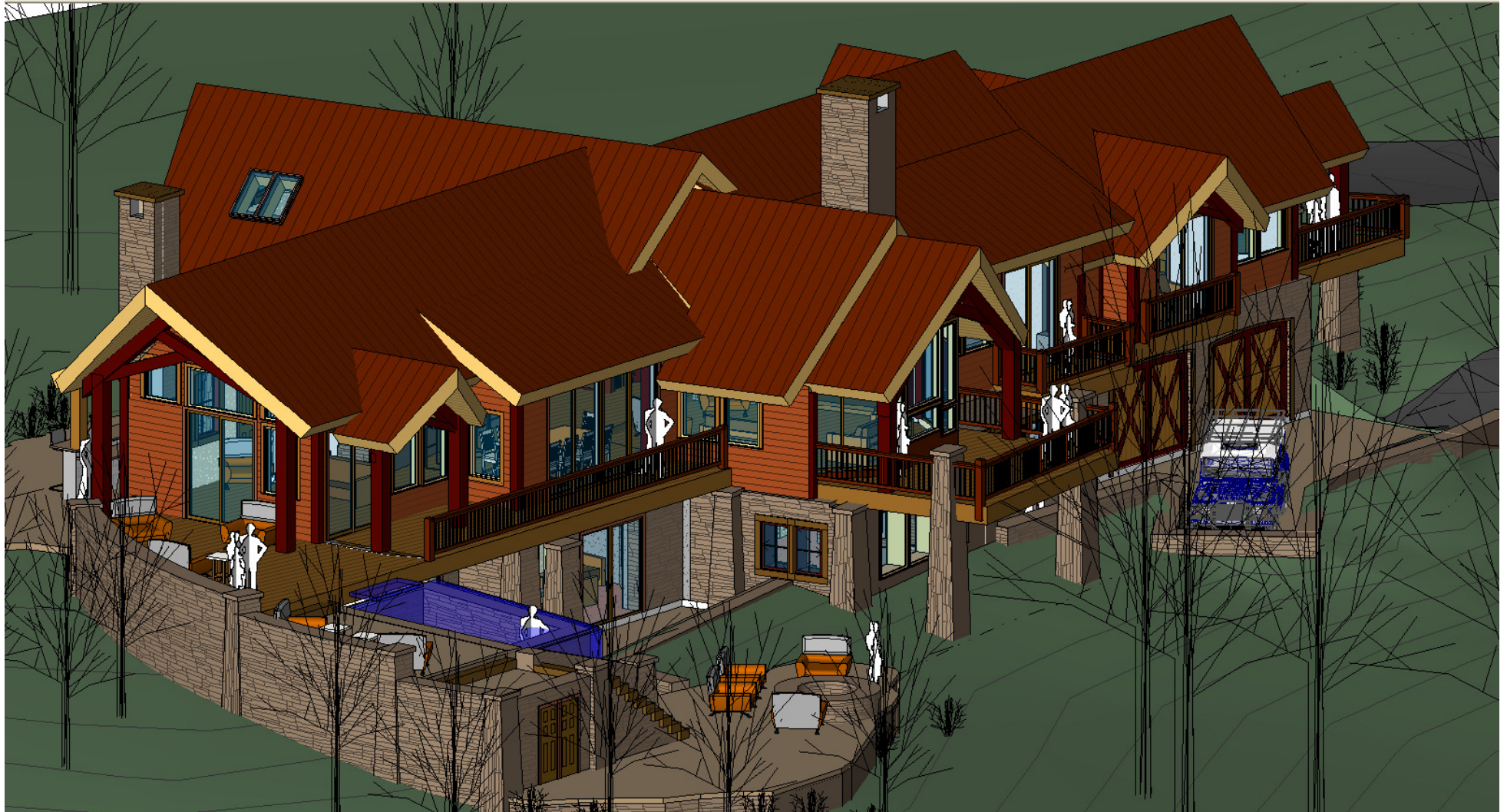

11-1-12: TELLURIDE Residence.

GR DESIGN GROUP, ARCHITECTS:

PROPERTY OF THE ARCHITECT.

970-728-0656 Cel: 970-708-1392

www.telluridearchitect.com

www.aspenarchitect.com

SCHEMATIC DESIGN:

NORTHEAST PERSPECTIVE:

The varied roofs emulate the rugged mountain peaks and are a result of the required 25'-0" maximum height limit on the site. Balancing the roofs with dormers along a changing slope, identify each space. No interior space is the same. Horizontal Cedar siding, Rusty Corrugated metal roofs and a stone base make up the exterior materials. Truss material is from recycled 100 year old timbers.

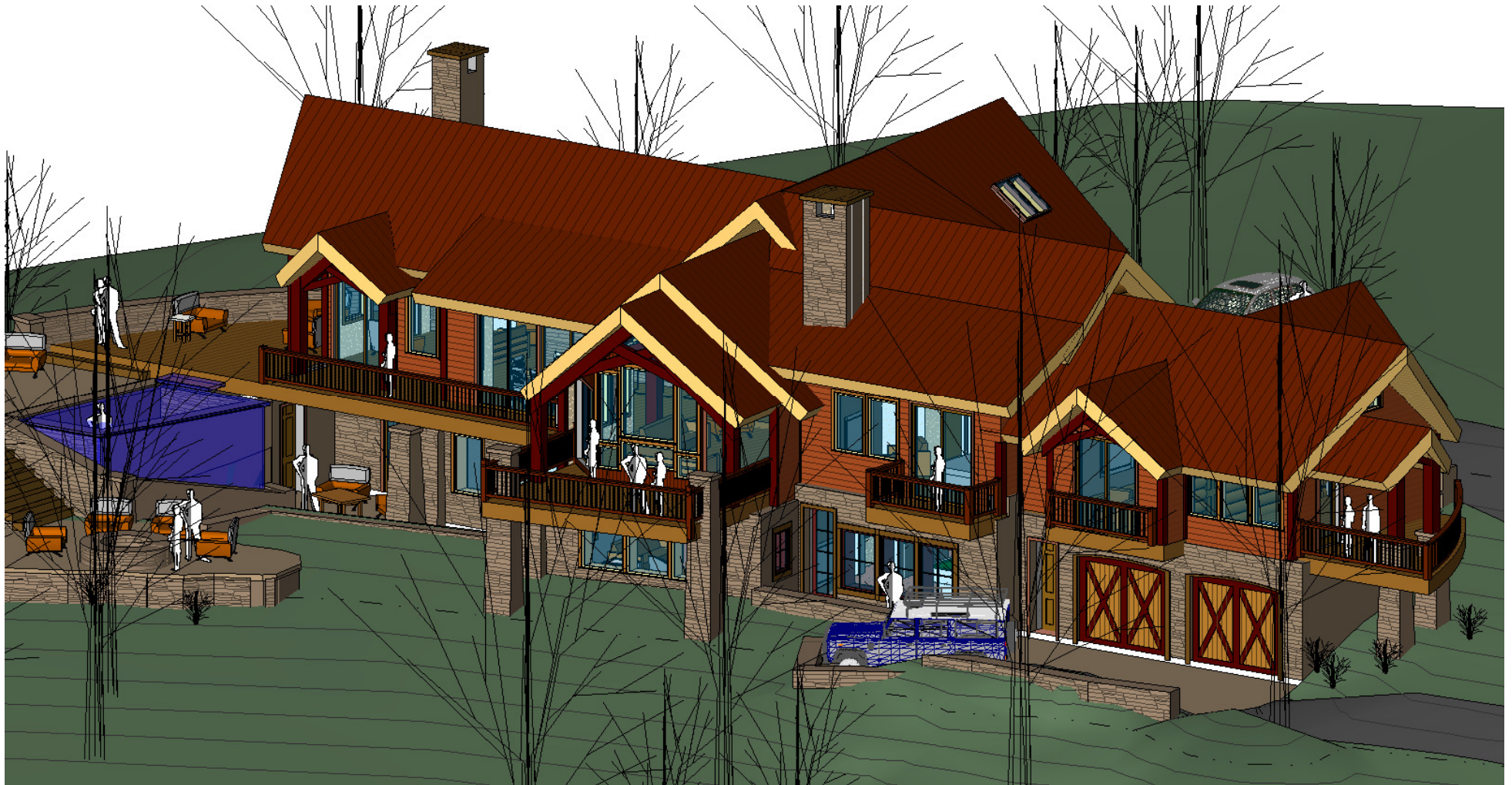

11-1-12: TELLURIDE Residence.

GR DESIGN GROUP, ARCHITECTS:

PROPERTY OF THE ARCHITECT.

[970-728-0656](tel:970-728-0656) [Cel: 970-708-1392](tel:970-708-1392)

www.telluridearchitect.com

www.aspenarchitect.com

SCHEMATIC DESIGN:

NORTH WEST VIEW:

ENTRY APPROACH PERSPECTIVE: As you approach the home through the aspen trees, views of the box canyon captivate your attention. The closest roof lines gather you in, gently increase in height, delivering you to the covered Porte Cochere entry. Mt. Wilson comes into view and is framed perfectly. A grand entry with lighting in the stone walls and a walnut front door.



11-1-12: TELLURIDE Residence.

GR DESIGN GROUP, ARCHITECTS:

PROPERTY OF THE ARCHITECT.

[970-728-0656](tel:970-728-0656) [Cel: 970-708-1392](tel:970-708-1392)

www.telluridearchitect.com

www.aspenarchitect.com

SCHEMATIC DESIGN:

SOUTHWEST PERSPECTIVE:

The panoramic views from the patio are spectacular. This will be a dynamic space to see Mt Wilson, jets arriving and taking off, Town of Telluride, and Ajax Peak. These views are also seen from the Living Room and Kitchen Alcove as well. One can see the arrival of guest through a direct connection to the patio. The wood trusses and columns frame the window and door openings.



11-1-12: TELLURIDE Residence.
970-728-0656 Cel: 970-708-1392
SCHEMATIC DESIGN:

GR DESIGN GROUP, ARCHITECTS:
www.telluridearchitect.com
INFINITY POOL & ENTERTAINMENT AREA:

PROPERTY OF THE ARCHITECT.
www.aspenarchitect.com

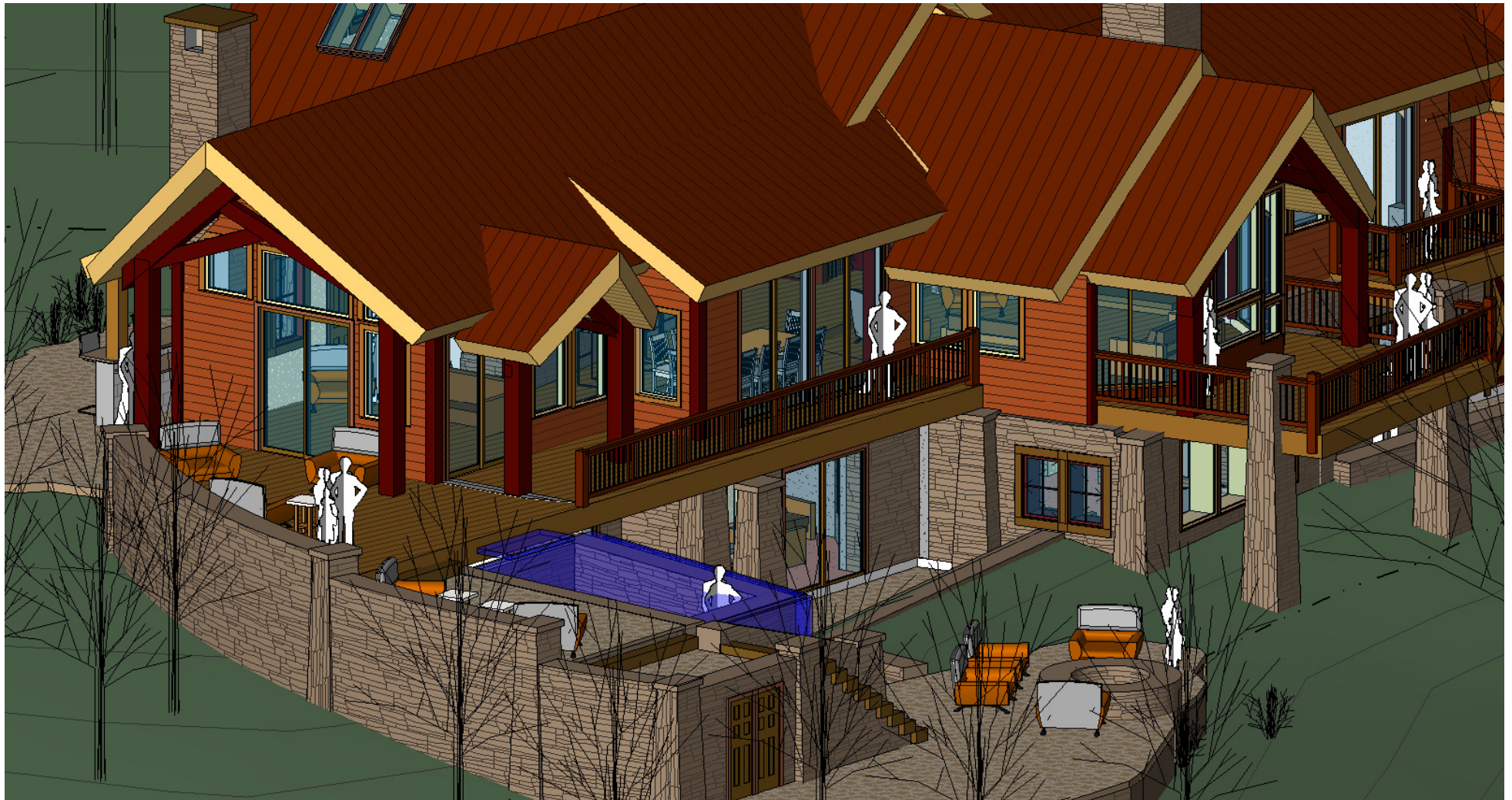

11-1-12: TELLURIDE Residence.
970-728-0656 Cel: 970-708-1392
SCHEMATIC DESIGN:

GR DESIGN GROUP, ARCHITECTS:
www.telluridearchitect.com
INFINITY POOL & ENTERTAINMENT AREA:

PROPERTY OF THE ARCHITECT.
www.aspenarchitect.com

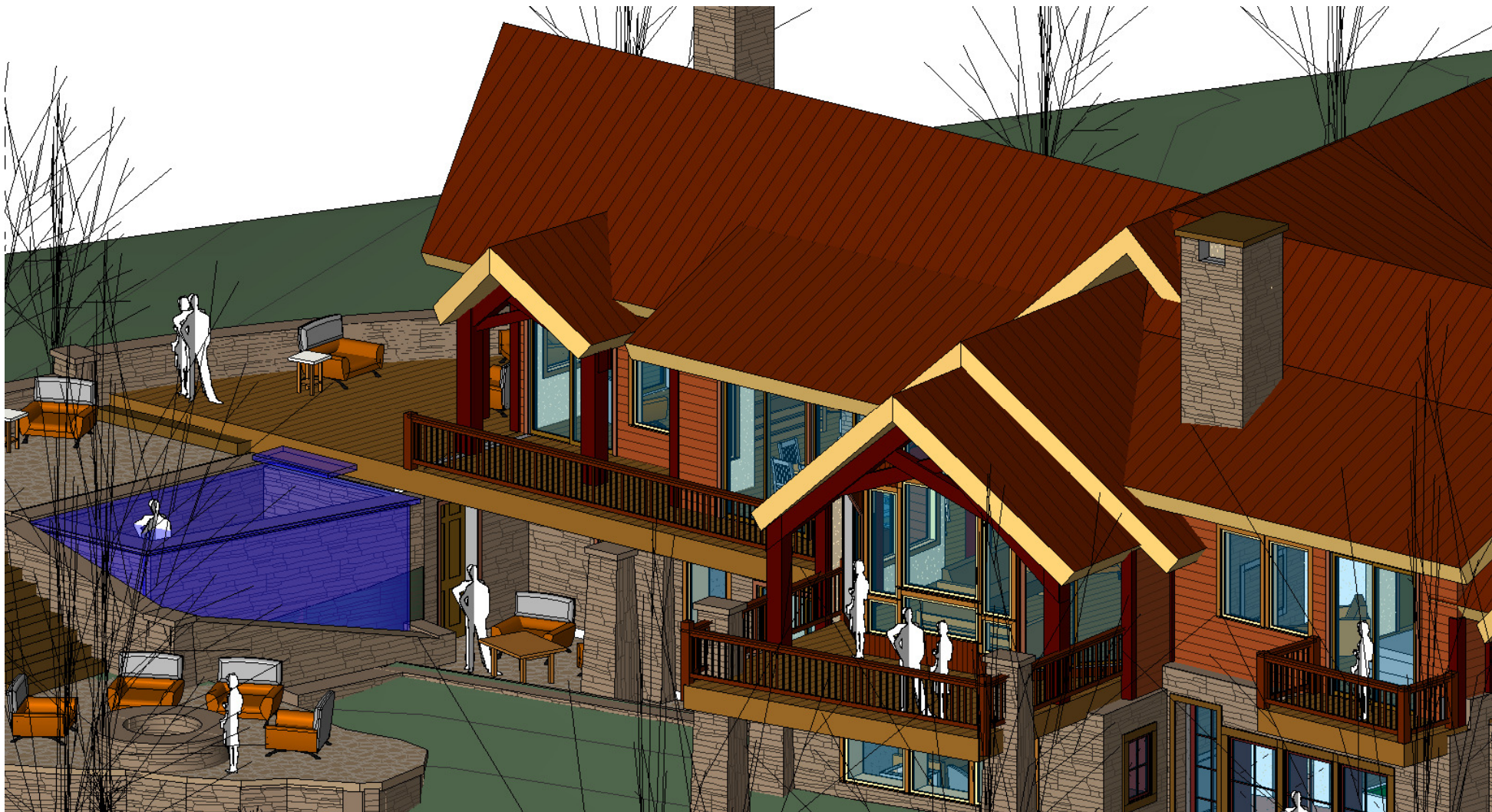

11-1-12: TELLURIDE Residence.
970-728-0656 Cel: 970-708-1392
SCHEMATIC DESIGN:

GR DESIGN GROUP, ARCHITECTS:
www.telluridearchitect.com
SITE PLAN:

PROPERTY OF THE ARCHITECT.
www.aspenarchitect.com

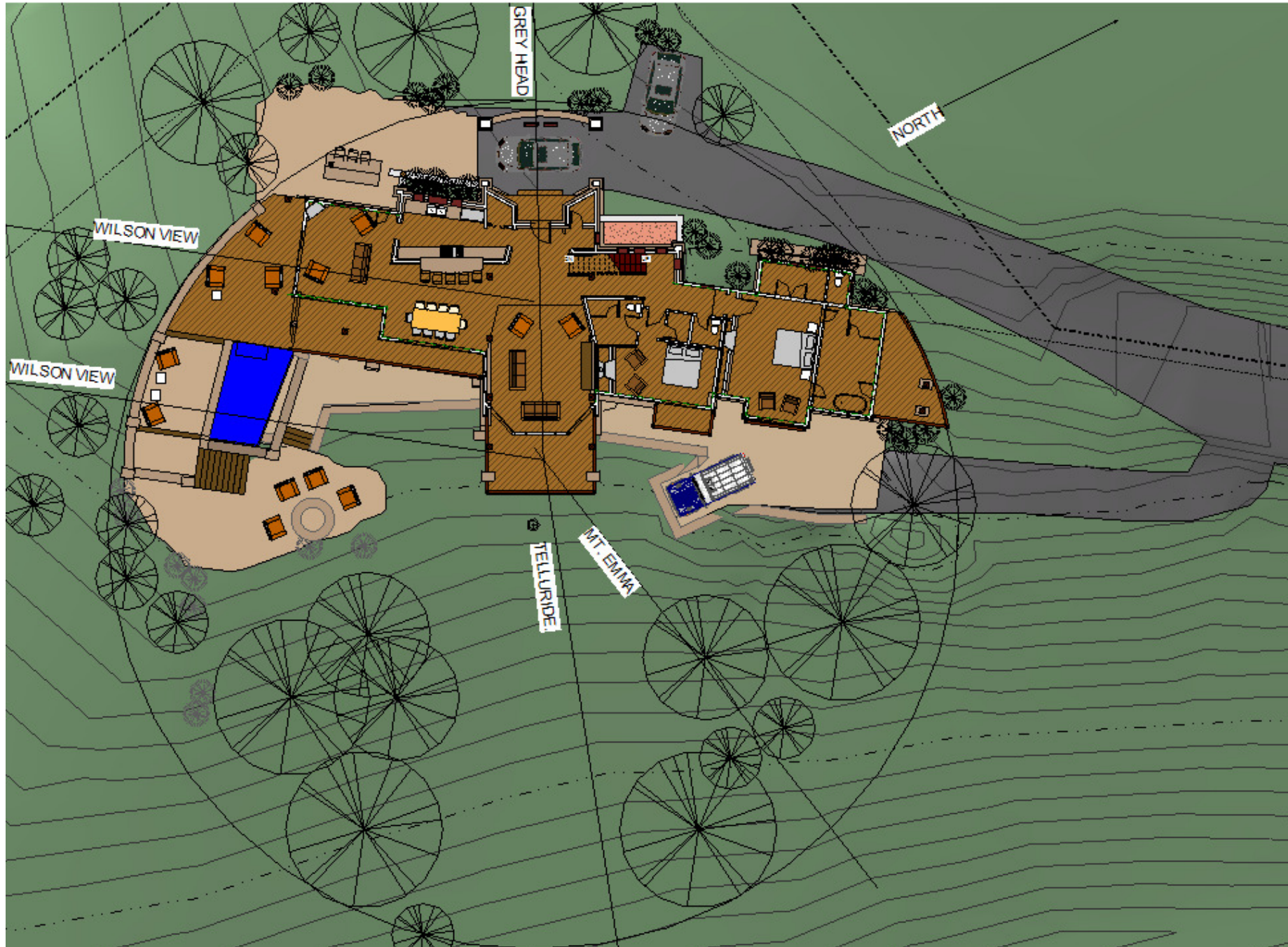

11-1-12: TELLURIDE Residence.
970-728-0656 Cel: 970-708-1392
SCHEMATIC DESIGN:

GR DESIGN GROUP, ARCHITECTS:
www.telluridearchitect.com
MAIN LEVEL :

PROPERTY OF THE ARCHITECT.
www.aspenarchitect.com

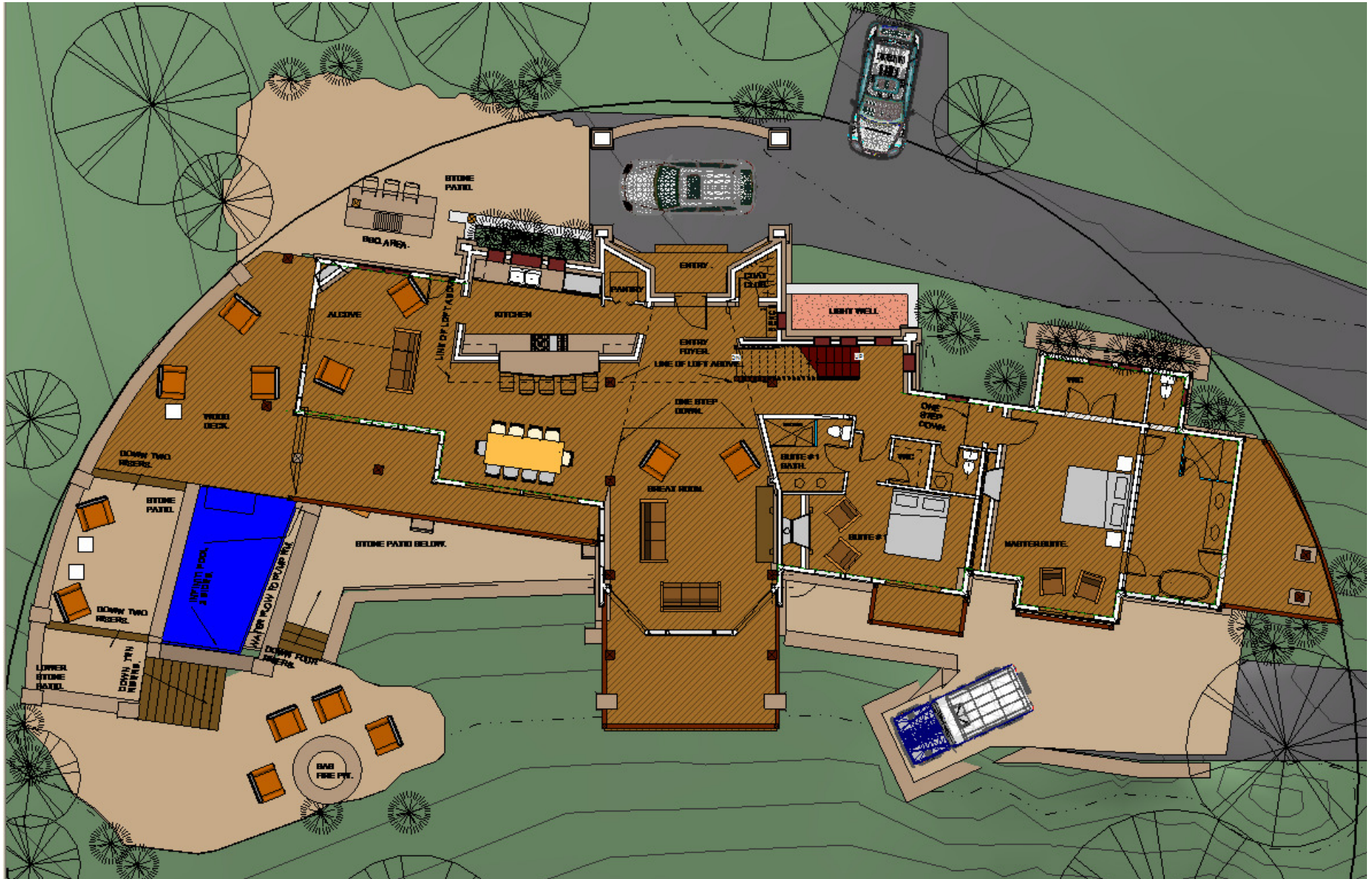

11-1-12: TELLURIDE Residence.
970-728-0656 Cel: 970-708-1392
SCHEMATIC DESIGN:

GR DESIGN GROUP, ARCHITECTS:
www.telluridearchitect.com
LOWER LEVEL :

PROPERTY OF THE ARCHITECT.
www.aspenarchitect.com

